

KENSINGTON  
3-Way Diverter  
MODEL # 19271000

Pure Freude an Wasser

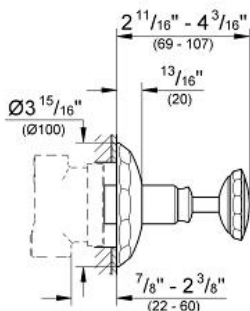

GROHE America, Inc | 200 North Gary Avenue, Suite G, Roselle, IL 60172  
Phone: +1 (800) 444-7643 | Fax: +1 (800) 225-2778 | us-customerservice@grohe.com



**Product Description:**  
3-Way Diverter

**Standard Specification:**

- For use with Diverter Rough-In Valve (29 712)
- Escutcheon with wall sealing
- Threaded
- Adjustable installation depth
- **GROHE StarLight** chrome finish

**Applicable Codes & Standards:**

- Energy Policy Act of 1992
- ASME A112.18.1/CSA B125.1

**Color:**

- 19271000 StarLight Chrome